

## Lead Lined Hollow Metal Door Frame Quote Request Form

Company: \_\_\_\_\_ Project Name: \_\_\_\_\_ Date: \_\_\_\_\_  
 Contact: \_\_\_\_\_ Ship City, State: \_\_\_\_\_ Zip Code: \_\_\_\_\_ Quote Req'd by: \_\_\_\_\_  
 Email: \_\_\_\_\_ Phone #: \_\_\_\_\_ Fax#: \_\_\_\_\_

**Choose Material:**  CRS (std)  A60 Galv  Other: \_\_\_\_\_ **Choose Gage:**  16 (std)  14  12 **Jamb:**  2" (std)  4"  \_\_\_\_\_ **Head:**  2" (std)  4"  \_\_\_\_\_

**Anchors:**  Steel Stud "Z" (std at Welded Frames)  Wood Stud  Masonry Strap  Existing Opening (EO)  Compression (std at KD frames)  See attached drawing

**Profile:**  Masonry (std)  Drywall return **Rabbet Type:**  Double Rabbet (std)  Single Rabbet  See attached drawing **Construction Type:**  Set-Up and Welded  Knock Down (KD)

**Notes:** 1. Frames are prime painted gray. 2. Heads are reinforced for regular & parallel arm closers. 3. All frames on this sheet to have same gage, material, profile, etc.

Item	Qty	Lead	Sgl / Pr	Rating	Width	Height	Wall Thk	Type 1 or 2	Hinges or Pivots	Strike or Flush Bolt	Special Preps, Instructions, etc.
A					x	x					
B					x	x					
C					x	x					
D					x	x					
E					x	x					
F					x	x					
G					x	x					
H					x	x					
I					x	x					
J					x	x					
K					x	x					

Notes / Remarks:

**TYPE 1 DOOR FRAME:**

Lead lined door is on the same side of wall as lead shielding

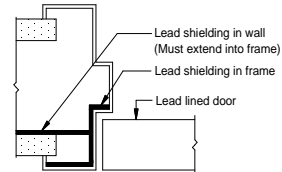

**TYPE 2 DOOR FRAME:**

Lead lined door is on the opposite side of wall from lead shielding

